

# Make a Mini Laurel Museum!



The Laurel Museum is temporarily closed due to the COVID-19 crisis but you can still keep in touch by making your own miniature museum.

Print out the template, color it, and then cut and assemble! It works best on cardstock, but any regular paper will do. And you might need to cut a little bit off the bottom of the chimney. But make the museum your own!

Adults should supervise children with cutting and assembling.



Artwork by Monica Sturdivant. Instagram: @allmonicasart



For more information, and to stay connected with us, visit our website at [www.laurelhistoricalsociety.org](http://www.laurelhistoricalsociety.org) or call us at 301-725-7975.

**Laurel Historical Society, 817 Main Street, Laurel, MD 20707**

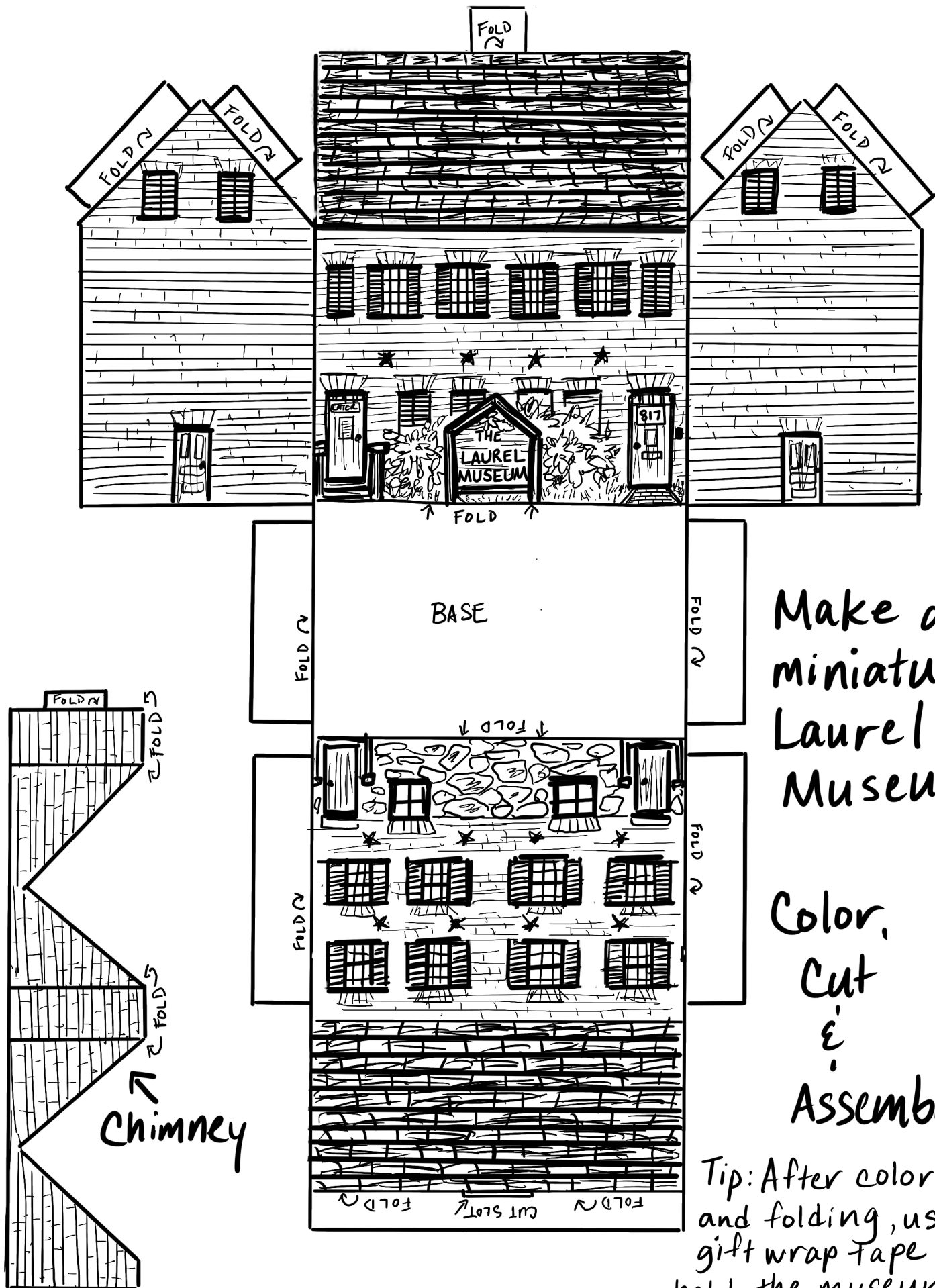

Make a  
miniature  
Laurel  
Museum!

Color,  
Cut  
&  
Assemble!

Tip: After coloring  
and folding, use  
gift wrap tape to  
hold the museum  
and chimney in place.